

NOTE
DOES
NOT
CUT
THRU

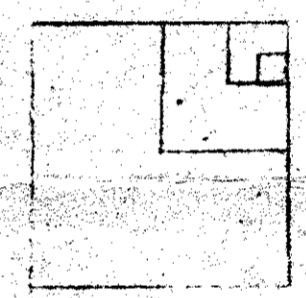

ur03461gr
PB COUNTRY ESTATES 41-41-3 UNIT J
LOTS J-121-240

1. PARCELS IN EXCESS OF 2.5 ACRES ARE SO MARKED WITH ACREAGE THEREIN.
 2. UNMARKED PARCELS ARE 2.5 ACRES.
 3. ALL ACREAGE VALUES ARE PLUS OR MINUS.
- ALL ROAD EASEMENTS ARE GOFT (BEING 50 FT EACH PARCEL) EXCEPT FOR NORTH-SOUTH SECTION LINES AND 1/4 SECTION WHICH ARE 80 FT (GOFT EACH PARCEL)
- BASEMENTS FOR DRAINAGE ONLY ARE 80 FT (GOFT EACH PARCEL)

PALM BEACH COUNTRY ESTATES SECTION "J"

PALM BEACH COUNTY, FLORIDA
FOR PALM BEACH DEVELOPMENT AND SALES CORP.

E. Solkoff
FLA. E.S. 1620
Eng 6487

REV. 3-22-67

SECTION 3, TOWNSHIP 41 SOUTH, RANGE 4 EAST

AS CONTAINED IN THE REPLAT OF JUPITER FARMS AND GROVES, ACCORDING TO THE PLAT THEREOF RECORDED IN PLAT BOOK 24, PAGE 7 OF THE PUBLIC RECORDS OF PALM BEACH COUNTY, FLORIDA, SUBJECT TO THE EASEMENTS FOR CANALS AND ROADS SHOWN THEREIN AND FOR PRIVATE RIGHTS OF WAY AS SHOWN HERETO.

DATE JAN. 11, 1967

E. SOLKOFF & ASSOCIATES
ENGINEERS & SURVEYORS
206 TENTH STREET
LAKE PARK, FLORIDA 33403

SCALE 1" = 400'
PLAT 1051-14